



*little faces*  
HEALING SPACES

HDR



CONTINUUM OF CARE | HEAL, CARE, WORK **BETTER.**

The experienced team at HDR Architecture recognizes the unique physical and emotional needs associated with creating healing spaces for little faces. We are dedicated to incorporating advanced evidence-based design concepts that contribute to the healing process of this very special patient population, and the roles that a caregiver and family play in improving clinical outcomes. Our work is shaped by a set of Guiding Principles to Pediatric Spaces that influences all architecture and design decisions. Our constant goal is the thoughtful design of innovative healthcare environments for pediatric care.



## HDR's Guiding Principles to Pediatric Spaces

- Recognize that family is most important to the patient.
- Provide for patient privacy, yet maintain observation, safety and accessibility.
- Have a unique aesthetic appropriate to all ages and developmental levels.
- Provide patients with a sense of control of their environment.
- Incorporate evidence-based design concepts to promote healing.
- Support the physical and social needs of patients, families and caregivers.
- Respect the social, cultural, language, ability and spirit of patients, families and caregivers.
- Respect the environment and natural resources.
- Incorporate technology and innovation into the delivery of care.
- Integrate the clinical side of children's hospitals with their education and research components.





## Services

Architecture

Engineering

Interior Design

Operational and Clinical Planning

Functional and Space Programming

Medical Equipment Planning

Urban and Campus Planning

Signage

Wayfinding Planning & Design

Technology Consulting

Security Consulting

Landscape Architecture

Sustainable Consulting

Design/Build Alternative Delivery

Product Design

Commissioning

Post-occupancy Evaluation

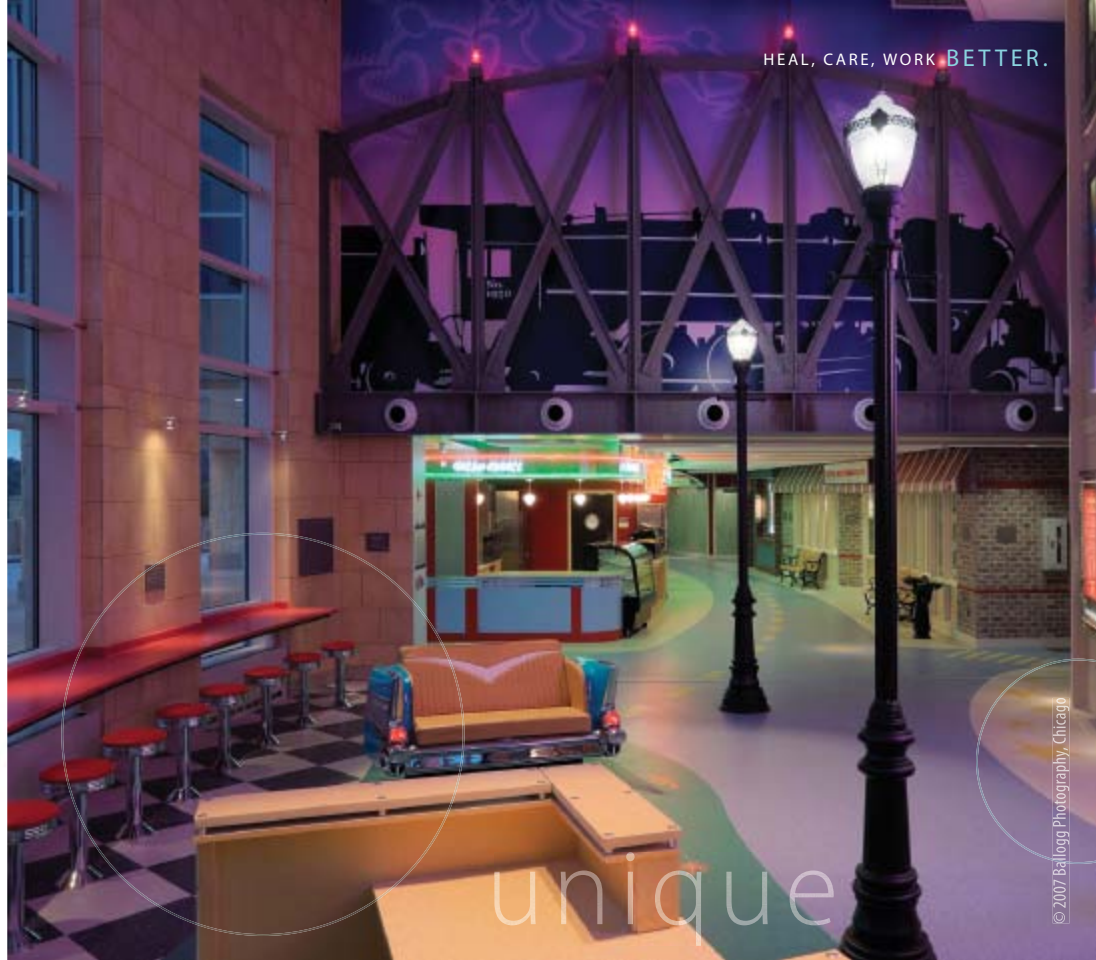

HEAL, CARE, WORK BETTER.

unique

## Cardon Children's Medical Center

Mesa, AZ

The East Valley is home to nearly 350,000 children – and to the new Cardon Children's Medical Center. More than 7,000 babies are born at Cardon Children's Medical Center each year, and the facility has the state's busiest emergency department with thousands of children's cases each year. The new pediatric hospital's seven floors feature an environment conducive to healing, including many indigenous materials and plants, imparting a non-threatening, familiar feeling. Water, trees and natural light grace the entrance and welcome all to the lobby. Patient rooms facing north and east have larger windows, while south- and west-facing rooms have smaller, punched windows. All patient bedrooms are private with ample family spaces.



HEAL, CARE, WORK BETTER.



healing

## Saint Alphonus Regional Medical Center

Boise, ID

Working with an internal “healing environment team,” a new Family Maternity Center and Neonatal Intensive Care Unit at Saint Alphonus were created to serve as the prototype for all future patient care units and as testing grounds for new concepts and materials. These are SARMC’s first environments that allow patients and family members to be partners in the care and healing process. The 32-position neonate unit was designed for Level III care and family spaces, including waiting and a child’s play area, a family lounge and nourishment area, lactation rooms and sleep rooms with showers. Two transition rooms provide private patient amenities for mother and neonate as a transition into the home setting.



HEAL, CARE, WORK BETTER.



family spaces

## Children's Hospital & Medical Center

Omaha, NE

When Children's Hospital needed space to grow, HDR designed its new state-of-the-art home, a facility that consolidated functions and allowed for the expansion of essential services and departments just for children. Easily distinguishable as a children's facility, a whimsical playfulness throughout the interiors creates a warm, healing environment. Nature is brought indoors in a two-story glass atrium featuring a brook and trees and a sky-lit play space. HDR has also designed the hospital's new Specialty Pediatric Center, an expansion that will connect to the existing hospital and provide expanded space for outpatient specialty care.



© Tom Kessler Photography



whimsical

## American Family Children's Hospital

Madison, WI

American Family Children's Hospital is a state-of-the-art pediatric hospital which provides an uplifting, healing environment for some of Wisconsin's smallest faces. The vision for the new hospital called for a facility with its own distinct identity, one that was family-focused and patient-friendly, and had an atmosphere that was imaginative and "child-like," but not childish. An "Interior Concepts" retreat brought together the insights of hospital administrators, staff, patients and families. The final interiors theme became "All Things Wisconsin." This magical healthcare facility has successfully translated hopeful visions into a spectacular reality. Described one patient's mother, "It's so big and bright and open; it's just a happier place."



HEAL, CARE, WORK BETTER.



magical

## Tripler Army Medical Center NICU

Honolulu, HI

The U.S. Army Corp of Engineers selected HDR to renovate and expand the Tripler Army Medical Center NICU. RIM Architects - Hawaii is assisting HDR on this project. In meetings with staff, HDR discussed the use of both the private room NICU and a hybrid model. Consideration will be given to space limitations, provider preference, and patient preference in determining whether to evolve their “ward” model to the hybrid model or a private room NICU. Design will require consideration of phasing as the existing nursery will be maintained and functional until the new nursery can be opened. Once the new one is opened, the existing nursery area will be renovated.



## St. Paul Children's Hospital

St. Paul, MN

More space, advanced technology and family-centered healing environments are among the major elements HDR has incorporated in the renovation of the St. Paul Children's Hospital. The renovation reflects the hospital's continuing commitment to children and their families. Planned enhancements and expansion includes enlarged single patient rooms where parents can comfortably stay around the clock with their children; a renovated and expanded emergency room; new operating rooms with enhanced technology and more space; relocation and enhancement of the Pediatric Epilepsy Unit; expanded neonatal services; and a new and distinct Children's entrance with an inviting three-story atrium lobby. In addition, terraces and rooftop gardens will be added to create green spaces for families and employees.



## Betty H. Cameron Women's and Children's Hospital, New Hanover Regional Medical Center

Wilmington, NC

HDR, in association with LS3P Associates, performed master planning and full design services for this region's premier hospital serving the special needs of women and children in southeastern North Carolina and beyond. The \$54 million, 194,300-square-foot facility is home to expert physicians and staff in addition to some of the state's most technically advanced medical equipment. With amply-sized same-handed rooms that accommodate family caregivers, all-private NICU/transitional rooms, decentralized nurse stations and wireless technology, the 150-bed hospital offers a comprehensive continuum of care for women and children in a family-centered environment.



©2008 Anne Gummerson Photography



warm

## Children's National Medical Center Inpatient Unit Fit Out

Washington, DC

With a mandate to help CNMC provide family-centered, world-class care in the safest environment possible, HDR created a set of design principles for this new patient room project to include patient- and family-centered private rooms, wireless technology, real-time data monitoring, decentralized services and staff, a quiet environment, efficient workflow and staff flow, and improved signage and wayfinding. The new patient rooms are zoned to allow medical staff immediate access to patients while accommodating family members to encourage their participation in the care of the patient. HDR's functional and space program for this inpatient unit was designed to help the hospital realize its mission of reducing the stress associated with pediatric hospital stays.



HEAL, CARE, WORK BETTER.



# HDR

[www.hdrinc.com](http://www.hdrinc.com)

© 2009 HDR Architecture, Inc., all rights reserved.



*HDR is committed to reducing our environmental impact through increased use of recycled post-consumer materials.*



0023940 08 09